

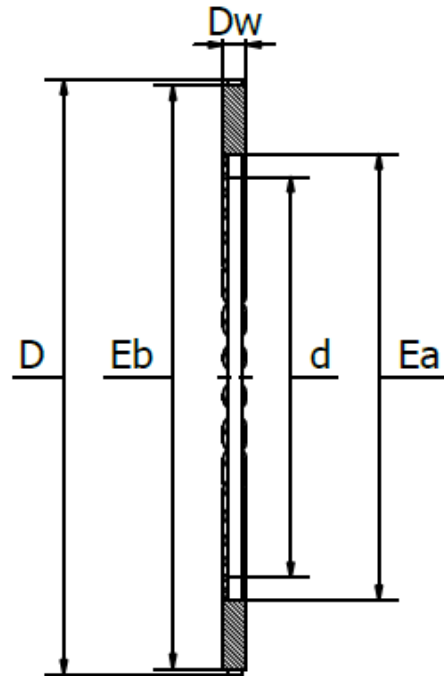

AXK Series - Needle Thrust Bearings

Single direction, to DIN 5405-2.



Item No.	Dimensions (mm)					Basic Load Ratings (kN)		Max. Speed (RPM)		Weight (g)
	d	D	Dw	Ea	Eb	Dynamic C_r	Static C_{0r}	Reference	Limiting	
AXK0414	4	14	2	min. 5	max. 13	4,15	8,3	7.500	15.000	1
AXK0515	5	15	2	min. 6	max. 14	4,50	9,5	6.700	14.000	1
AXK0619	6	19	2	min. 7	max. 18	6,30	16,0	6.000	12.000	1
AXK0821	8	21	2	min. 9	max. 20	7,20	20,0	5.600	11.000	2
AXK1024	10	24	2	min. 12	max. 23	8,50	26,0	5300	10000	3
AXK1226	12	26	2	min. 14	max. 25	9,15	30,0	5000	10000	3
AXK1528	15	28	2	min. 17	max. 27	10,40	37,5	4800	9500	4
AXK1730	17	30	2	min. 19	max. 29	11,00	40,5	4500	9500	4
AXK2035	20	35	2	min. 22	max. 34	12,00	47,5	4300	8500	5
AXK2542	25	42	2	min. 29	max. 42	13,40	60,0	3800	7500	7
AXK3047	30	47	2	min. 34	max. 46	15,00	72,0	3600	7000	8
AXK3552	35	52	2	min. 39	max. 51	16,60	83,0	3200	6300	10
AXK4060	40	60	2	min. 45	max. 58	25,00	114,0	2800	5600	16
AXK4665	45	65	2	min. 50	max. 63	27,00	127,0	2600	5300	18
AXK5070	50	70	2	min. 55	max. 68	28,50	143,0	2400	5000	20
AXK5578	55	78	2	min. 60	max. 76	34,50	186,0	2200	4300	28
AXK6085	60	85	2	min. 65	max. 83	37,50	232,0	2200	4300	33