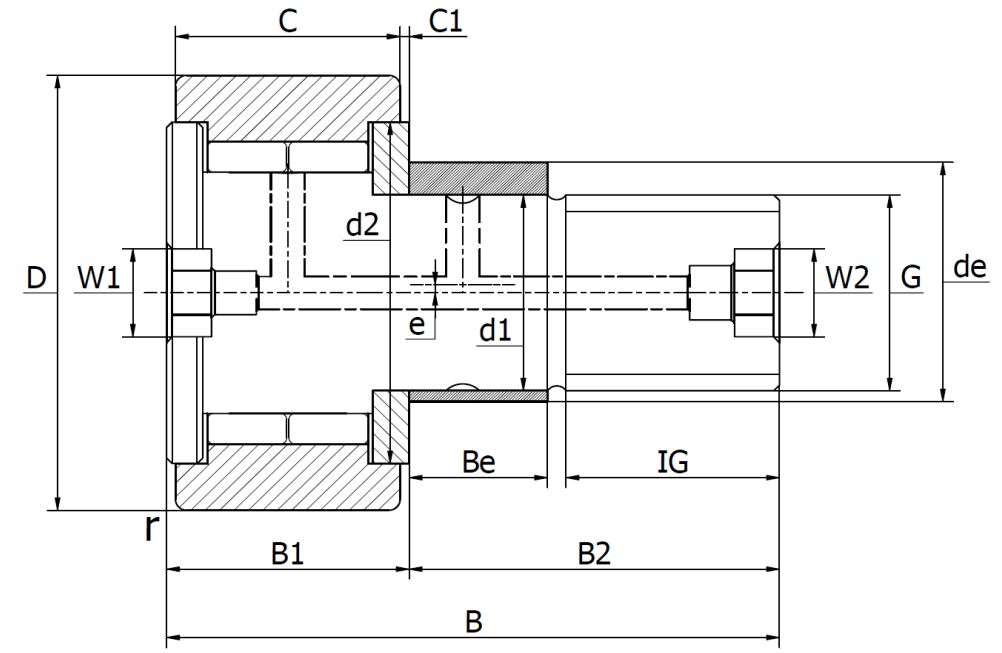

Size 35 & 40

Size 47 to 90

Item No.	Dimensions (mm)																Mass (g)	M _A (Nm)	Load rating (N)			n _{DG} (1/min)
	D	de	B	B1 max	B2	Be	C	C1	d1	d2	e	G	IG	r _{min}	W1	W2			C _{r w}	C _{0r w}	C _{ur w}	
PWKRE35-2RS	35	20	52	19,5	32,5	12	18	0,8	16	20	1	M16X1,5	17	0,6	8	8	177	58	12600	14600	1760	6000
PWKRE40-2RS	40	22	58	21,6	36,5	14	20	0,8	18	22	1	M18X1,5	19	1	8	8	258	87	14300	17900	2160	5000
PWKRE47-2RS	47	24	66	25,6	40,5	18	24	0,8	20	27	1	M20X1,5	21	1	10	10	400	120	24500	30500	3750	3800
PWKRE52-2RS	52	24	66	25,6	40,5	18	24	0,8	20	31	1	M20X1,5	21	1	10	10	470	120	25000	33000	4100	3800
PWKRE62-2RS	62	28	80	30,6	49,5	22	29	0,8	24	38	1	M24X1,5	25	1	14	14	824	220	35000	45500	5800	2200
PWKRE72-2RS	72	28	80	30,5	49,5	22	29	0,8	24	44	1	M24X1,5	25	1	14	14	1050	220	38500	54000	6900	2200
PWKRE80-2RS	80	35	100	37,6	63	29	35	1	30	47	1,5	M30X1,5	32	1,1	14	14	1670	450	56000	79000	10600	1800
PWKRE90-2RS	90	35	100	37,6	63	29	35	1	30	47	1,5	M30X1,5	32	1,1	14	14	2020	450	62000	92000	12200	1800

Legend:

- d₁** Tolerance: h7
- W** Nominal dimension for hexagonal socket
- M_A** Nut tightening torque
- C_{r w}** Effective dynamic load rating as track roller (radial)
- C_{0r w}** Effective static load rating as track roller (radial)
- C_{ur w}** Fatigue limit load
- n_{DG}** Speed (with continuous operation and grease lubrication)
- de** Eccentric collar, tolerance: h9
- e** Maximum eccentric collar offset

Lubrication nipple:

Every item is shipped with a drive fit lubrication nipple and a plug.

