

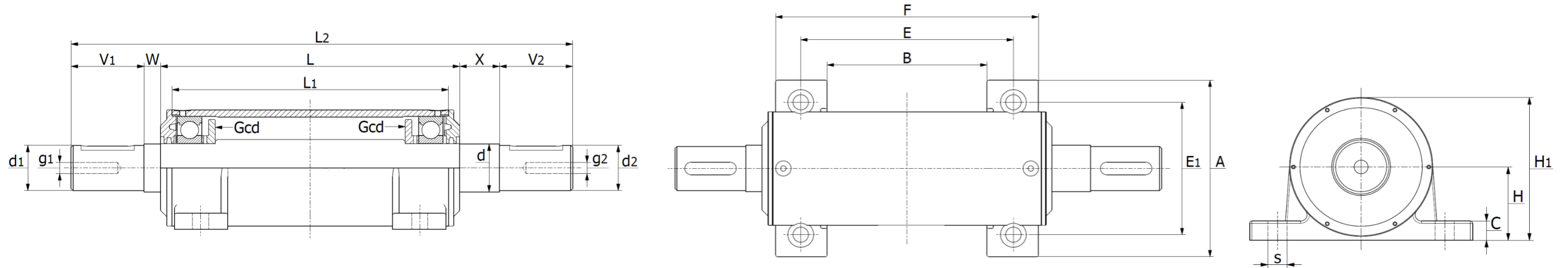

## BL-W Series - Fan Bearing Housings

Unit with shaft, groove for key, lithium based NLGI 2/3 grease, optional grease control discs for ball bearings. Impeller side right, belt drive side left.



These housings are especially suitable for ventilation fans running with a higher speed than common pillow blocks. Since misalignment errors are largely excluded, ball and roller bearings can be installed in these housings. The grease quantity control discs on both sides simplify maintenance and throw excess grease into the middle of the large housing space.

Part No.	Dimensions (mm)										Bearings		Spring	Max. Speed	First fill	Regreasing	Weight											
	d	d1	d2	L	L1	L2	V1	V2	w	x	g1	g2	A	F	E	E1	B	H1	H	C	s	Left (belt drive)	Right (impeller)	Washer	(rpm)	(g)	(g)	(kg)
BL-W 25	25	24	24	218	184	358	50	50	20	20	M8	M8	155	171	135	120	89	95	50	16	11,5	6305 C3	6305 C3	6200-6305	11000	50	5	9,5
BL-W 30	30	28	28	300	266	470	50	50	50	20	M10	M10	170	250	210	130	150	100	50	18	11,5	6306 C3	6306 C3	6200-6306	9500	60	5	12,0
BL-W 35	35	32	32	330	296	530	60	60	55	25	M12	M12	190	260	240	150	160	120	60	20	15	6307 C3	6307 C3	6200-6307	8500	80	5	17,0
BL-W 40	40	38	38	330	296	530	60	60	55	25	M12	M12	190	260	240	150	160	120	60	20	15	6308 C3	6308 C3	6200-6308	7500	110	10	18,0
BL-W 45	45	42	42	365	331	575	65	65	55	25	M16	M16	190	313	263	150	193	140	70	23	15	6308 C3	6308 C3	6200-6309	6700	110	10	28,0
BL-W 50	50	48	48	365	331	585	70	70	55	25	M16	M16	190	313	263	150	193	140	70	23	15	6310 C3	6310 C3	6200-6310	5300	140	15	37,0
BL-W 50 S-W 535	60	50	38	550	516	944	158	80	16	140	-	M12	190	498	448	150	358	140	70	23	15	6212 C3	6212 C3	6200-6212	5300	140	15	41,3
BL-W 50 S-W 536	60	50	42	550	516	974	158	110	16	140	-	M12	190	498	448	150	358	140	70	23	15	6212 C3	6212 C3	6200-6212	5300	140	15	45,3
BL-W 50 S-W 538	60	60	48	550	516	974	174	110	-	140	-	M16	190	498	448	150	358	140	70	23	15	6212 C3	6212 C3	6200-6212	5300	140	15	44,8
BL-W 50 S-W 539	60	60	55	550	516	974	174	110	-	140	-	M20	190	498	448	150	358	140	70	23	15	6212 C3	6212 C3	6200-6212	5300	140	15	44,8
BL-W 60	60	55	55	405	371	645	80	80	55	-	M20	M20	210	255	295	170	115	160	80	25	20	6312 C3	6312 C3	6200-6312	5000	140	10	39,0
BL-W 60 SS 760	75	65	48	737	706	1142	151	110	19	125	-	M16	209	656	595	170	502	162	80	25	20	NU215	6215 C3	6200-6215	4400	140	10	75,4
BL-W 60 SS 761	75	65	55	737	706	1142	151	110	19	125	-	M20	209	656	595	170	502	162	80	25	20	NU215	6215 C3	6200-6215	4400	140	10	75,8
BL-W 60 SS 762	75	65	60	737	706	1172	151	140	19	125	-	M20	209	656	595	170	502	162	80	25	20	NU215	6215 C3	6200-6215	4400	140	10	70,8
BL-W 60 SS 763	75	75	70	737	706	1172	170	140	-	125	-	M20	209	656	595	170	502	162	80	25	20	NU215	6215 C3	6200-6215	4400	140	10	70,8
BL-W 70	70	65	65	450	416	755	110	110	60	25	M20	M20	280	408	330	210	248	185	95	25	24	6314 C3	6314 C3	6200-6314	4300	190	10	63,0
BL-W 70 SPEC	70	70	60	450	416	801	147	140	-	64	-	M20	280	408	330	210	248	185	95	25	24	6314 C3	6314 C3	6200-6314	4300	190	10	64,0
BL-W 75	75	70	70	450	416	755	110	110	58	27	M20	M20	280	408	330	210	248	185	95	25	24	6315 C3	6315 C3	6200-6315	4000	190	10	64,0
BL-W 80	80	75	75	490	450	805	110	110	70	25	M20	M20	320	435	350	230	265	220	112	30	24	6316 C3	6316 C3	6200-6316	3800	240	15	84,0
BL-W 80 SPEC	84	80	70	490	450	845	148,5	140	-	66,5	-	M20	320	435	350	230	265	220	112	30	24	6316 C3	6316 C3	6200-6316	3800	240	15	88,0
BL-W 90	90	85	85	590	566	935	120	120	80	25	M20	M20	355	526	450	280	248	236	120	35	24	6318 C3	6318 C3	6200-6318	3400	300	15	134,0
BL-W 90 P-L	90	80	90	590	566	1010	169	179,5	-	71,5	M20	-	355	526	450	280	248	236	120	35	24	6318 C3	6318 C3	6200-6318	3400	300	15	141,0
BL-W 90 P-L SPEC	90	75	75	590	566	935	120	120	40	65	-	-	355	526	450	280	248	236	120	35	24	6318 C3	6318 C3	6200-6318	3400	300	15	133,0
BL-W 100 SPEC	100	90	90	590	562	985	120	170	80	25	M20	M20	400	552	480	335	344	287	145	40	24	6320 C3	6320 C3	6200-6320	3000	300	15	198,0