

## 6400 Series - Single Row Deep Groove Ball Bearings

Open non shielded version. Bearings with double-sided seals are filled with lithium soap grease as standard and can be used in temperature ranges from -30°C to +110°C.

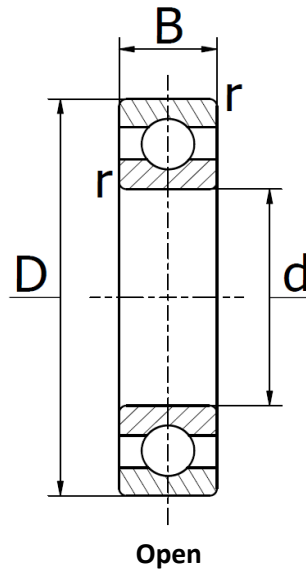

Item No.	Dimensions (mm)				Basic Load Ratings (N)		Limiting Speeds (RPM)	Mass (kg)
	d	D	B	$r_{min}$	Dynamic $C_r$	Static $C_{0r}$	Oil Open	approx.
6403	17	62	17	1,1	22.400	11.400	16.200	0,269
6404	20	72	19	1,1	29.000	16.300	13.700	0,414
6405	25	80	21	1,5	33.500	19.000	12.300	0,549
6406	30	90	23	1,5	42.500	25.000	10.800	0,740
6407	35	100	25	1,5	53.000	31.500	9.500	0,971
6408	40	110	27	2,0	62.000	38.000	9.500	0,805
6409	45	120	29	2,0	76.500	47.500	8.500	1,980
6410	50	130	31	2,1	81.500	52.000	7.900	1,960
6411	55	140	33	2,1	93.000	60.000	7.300	1,380
6412	60	150	35	2,1	104.000	68.000	6.800	2,830
6413	65	160	37	2,1	114.000	76.500	6.300	3,490
6414	70	180	42	3,0	132.000	96.500	5.000	5,060
6415	75	190	45	3,0	132.000	96.500	6.600	7,000
6416	80	200	48	3,0	163.000	125.000	5.900	8,290
6417	85	210	52	4,0	173.000	137.000	5.600	9,600
6418	90	225	54	4,0	196.000	163.000	5.200	11,700