

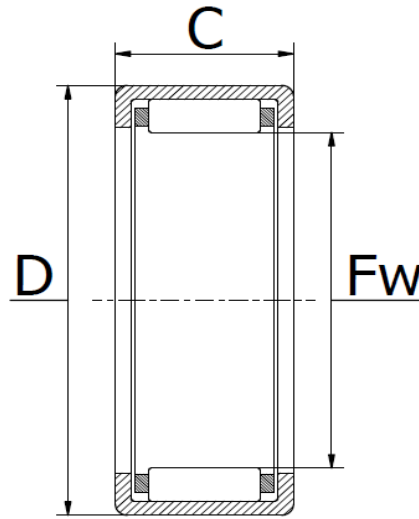

HK Series - Drawn Cup Needle Roller Bearings

open end, acc. to DIN 618/ISO 3245, max. temperature 140°C.

For use with IR inner rings or a ground and hardened shaft, tolerance h6, HRC 58-64, surface Ra0,2(Rz1), roundness and parallelism IT 3. Housing bore tolerance for steel and cast iron N6, aluminium R6, magnesium S6, surface Ra0,8(Rz4), roundness and parallelism IT 5/2.



Item No.	Dimensions (mm)			Weight (g)	Basic Load Ratings (N)		Max. Speed (RPM)	
	Fw	D	C		Dynamic C_r	Static C_{0r}	Oil	Grease
HK0306	3	6,5	6	1,0	1.170	800	43.700	26.220
HK0408	4	8	8	1,6	1.690	1.240	39.000	23.400
HK0509	5	9	9	2,0	2.280	1.890	36.000	21.600
HK0606	6	10	6	1,8	2.100	1.700	34.500	20.700
HK0608	6	10	8	2,1	1.900	1.570	33.200	19.920
HK0609	6	10	9	2,2	2.700	2.470	33.200	19.920
HK0709	7	11	9	2,3	2.950	2.800	29.400	17.640
HK0808	8	12	8	2,7	2.600	2.470	26.600	15.960
HK0810	8	12	10	3,0	3.600	3.750	26.600	15.960
HK0908	9	13	8	3,0	3.370	3.560	23.700	14.220
HK0910	9	13	10	4,0	4.050	4.400	23.700	14.220
HK0912	9	13	12	4,6	5.040	6.000	23.700	14.220
HK1010	10	14	10	4,1	4.180	4.850	23.700	14.220
HK1012	10	14	12	4,8	5.200	6.450	21.850	13.110
HK1015	10	14	15	6,0	6.450	8.350	21.850	13.110
HK1210	12	16	10	4,6	4.700	5.900	21.850	13.110
HK1212	12	18	12	9,0	6.150	6.900	19.000	11.400
HK1311	13	19	11	8,5	6.300	6.300	18.000	10.800
HK1312	13	19	12	8,9	6.450	7.500	14.000	8.400
HK1412	14	20	12	10,5	6.800	8.000	17.000	10.200
HK1512	15	21	12	11,1	7.500	8.950	15.200	9.120



HK Series - Drawn Cup Needle Roller Bearings

open end, acc. to DIN 618/ISO 3245, max. temperature 140°C.

For use with IR inner rings or a ground and hardened shaft, tolerance h6, HRC 58-64, surface Ra0,2(Rz1), roundness and parallelism IT 3. Housing bore tolerance for steel and cast iron N6, aluminium R6, magnesium S6, surface Ra0,8(Rz4), roundness and parallelism IT 5/2.

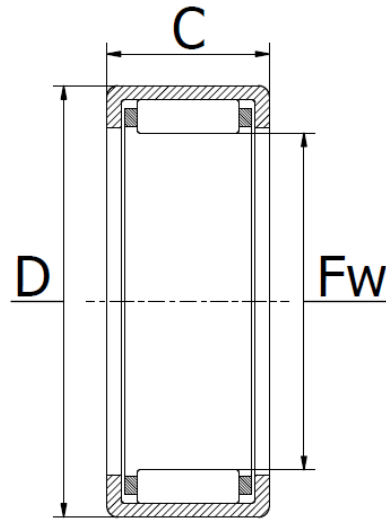

Item No.	Dimensions (mm)			Weight (g)	Basic Load Ratings (N)		Max. Speed (RPM)	
	Fw	D	C		Dynamic C_r	Static C_{0r}	Oil	Grease
HK1516	15	21	16	15,0	9.950	13.700	15.200	9.120
HK1522	15	21	22	20,4	12.700	18.500	15.200	9.120
HK1612	16	22	12	11,7	7.200	9.200	15.200	9.120
HK1616	16	22	16	15,8	10.300	14.500	14.200	8.520
HK1622	16	22	22	21,7	12.450	18.400	14.200	8.520
HK1712	17	23	12	12,2	7.500	9.750	13.300	7.980
HK1718	17	23	18	19,0	9.500	10.600	10.000	6.000
HK1812	18	24	12	13,1	7.700	10.350	12.350	7.410
HK1816	18	24	16	17,5	11.000	16.400	12.350	7.410
HK2010	20	26	10	11,8	6.100	7.800	11.400	6.840
HK2012	20	26	12	14,1	8.200	11.500	11.400	6.840
HK2016	20	26	16	19,3	12.000	19.100	11.400	6.840
HK2020	20	26	20	24,1	14.900	24.700	11.400	6.840
HK2030	20	26	30	34,7	20.700	38.000	11.400	6.840
HK2210	22	28	10	12,3	7.100	9.950	10.450	6.270
HK2212	22	28	12	15,0	8.650	12.700	10.450	6.270
HK2216	22	28	16	20,9	12.700	21.000	10.450	6.270
HK2220	22	28	20	26,2	15.650	27.550	10.450	6.270
HK2512	25	32	12	20,0	10.450	14.450	9.500	5.700
HK2516	25	32	16	27,3	14.800	22.800	9.500	5.700
HK2520	25	32	20	24,1	18.900	31.350	9.500	5.700



HK Series - Drawn Cup Needle Roller Bearings

open end, acc. to DIN 618/ISO 3245, max. temperature 140°C.

For use with IR inner rings or a ground and hardened shaft, tolerance h6, HRC 58-64, surface Ra0,2(Rz1), roundness and parallelism IT 3. Housing bore tolerance for steel and cast iron N6, aluminium R6, magnesium S6, surface Ra0,8(Rz4), roundness and parallelism IT 5/2.

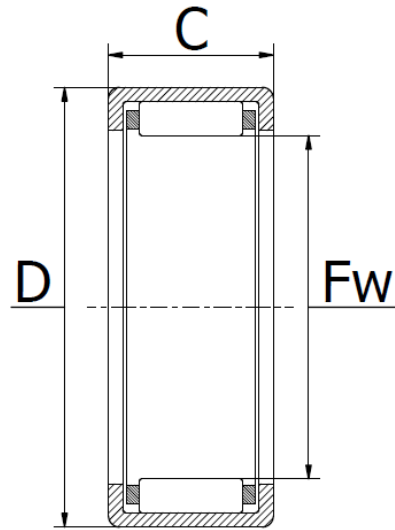

Item No.	Dimensions (mm)			Weight (g)	Basic Load Ratings (N)		Max. Speed (RPM)	
	Fw	D	C		Dynamic C_r	Static C_{0r}	Oil	Grease
HK2524	25	32	24	39,7	21.100	38.450	9.500	5.700
HK2526	25	32	26	44,8	24.200	42.750	9.500	5.700
HK2538	25	32	38	64,7	32.300	62.700	9.500	5.700
HK2816	28	35	16	30,1	15.600	25.200	8.550	5.130
HK2820	28	35	20	37,6	19.850	34.200	8.550	5.130
HK3012	30	37	12	24,0	11.500	17.300	8.100	4.860
HK3016	30	37	16	32,0	16.350	27.550	8.100	4.860
HK3020	30	37	20	40,1	20.900	37.500	8.100	4.860
HK3022	30	37	22	42,0	24.500	45.000	8.100	4.860
HK3026	30	37	26	52,9	26.600	51.300	8.100	4.860
HK3038	30	37	38	76,1	35.600	75.000	8.100	4.860
HK3220	32	39	20	40,6	22.500	42.000	7.300	4.380
HK3224	32	39	24	50,7	25.500	52.000	7.300	4.380
HK3512	35	42	12	27,7	12.450	20.250	7.150	4.290
HK3516	35	42	16	36,9	17.750	31.850	6.200	3.720
HK3520	35	42	20	46,1	22.600	43.700	6.150	3.690
HK4012	40	47	12	31,1	13.300	23.100	6.200	3.720
HK4016	40	47	16	41,4	19.000	36.600	6.200	3.720
HK4020	40	47	20	51,8	24.250	49.400	6.200	3.720
HK4512	45	52	12	34,8	14.150	26.150	5.700	3.420
HK4516	45	52	16	46,2	20.250	40.850	5.700	3.420



HK Series - Drawn Cup Needle Roller Bearings

open end, acc. to DIN 618/ISO 3245, max. temperature 140°C.

For use with IR inner rings or a ground and hardened shaft, tolerance h6, HRC 58-64, surface Ra0,2(Rz1), roundness and parallelism IT 3. Housing bore tolerance for steel and cast iron N6, aluminium R6, magnesium S6, surface Ra0,8(Rz4), roundness and parallelism IT 5/2.

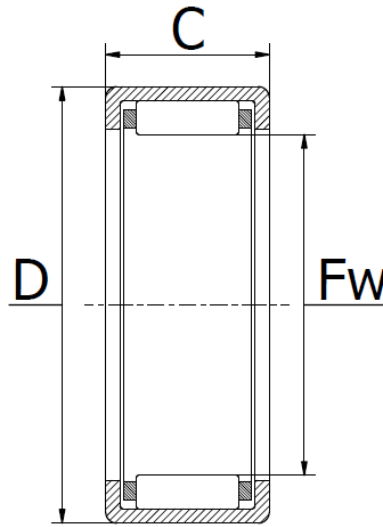

Item No.	Dimensions (mm)			Weight (g)	Basic Load Ratings (N)		Max. Speed (RPM)	
	Fw	D	C		Dynamic C_r	Static C_{0r}	Oil	Grease
HK4520	45	52	20	56,0	25.650	56.050	5.700	3.420
HK4538	45	55	38	135,0	27.600	61.000	5.300	3.180
HK5012	50	58	12	44,2	23.600	57.200	5.300	3.180
HK5020	50	58	20	72,0	29.450	59.850	4.750	2.850
HK5025	50	58	25	90,1	36.550	79.800	4.750	2.850
HK5038	50	58	38	140,0	27.770	63.100	4.600	2.760
HK5520	55	63	20	78,0	29.950	63.650	4.450	2.670
HK5528	55	63	28	111,0	41.800	97.850	4.080	2.448
HK6012	60	68	12	49,2	16.550	30.400	4.180	2.508
HK6020	60	68	20	86,0	31.800	71.250	4.180	2.508
HK6032	60	68	32	136,0	50.350	128.250	4.180	2.508