

Part No.	Material	Type	Belt width in mm	Taper bush	Ø Max.	Dimensions (mm)								Weight (kg)
						Dp	De	Df	Dm	Di	F	S	R	
HTD 28 14M 40	Steel	4F	40	2012	50	124,78	122,12	128	-	94	54	32	11	2,07
HTD 29 14M 40	Steel	4F	40	2012	50	129,23	126,57	138	-	98	54	32	11	2,38
HTD 30 14M 40	Steel	4F	40	2012	50	133,69	130,99	138	-	98	54	32	11	2,65
HTD 32 14M 40	Steel	4F	40	2012	50	142,60	139,88	154	-	108	54	32	11	3,40
HTD 34 14M 40	Steel	4F	40	2517	60	151,52	148,79	160	-	110	54	45	4,5	3,87
HTD 36 14M 40	Steel	4F	40	2517	60	160,43	157,68	168	-	120	54	45	4,5	4,80
HTD 38 14M 40	Steel	4F	40	2517	60	169,34	166,60	183	-	130	54	45	4,5	5,40
HTD 40 14M 40	Steel	4F	40	2517	60	178,25	175,49	188	-	138	54	45	4,5	6,00
HTD 44 14M 40	Steel	4F	40	3020	75	196,08	193,28	211	-	155	54	51	1,5	7,80
HTD 48 14M 40	Steel	4F	40	3020	75	213,90	211,11	226	-	170	54	51	1,5	9,40
HTD 56 14M 40	Steel	9WF	40	3020	75	249,55	246,76	256	170	208	54	51	1,5	10,80
HTD 64 14M 40	Cast iron	9WF	40	3020	75	285,21	282,41	296	170	240	54	51	1,5	13,40
HTD 72 14M 40	Cast iron	9W	40	3020	75	320,86	318,06	-	170	280	54	51	1,5	15,20
HTD 80 14M 40	Cast iron	9A	40	3020	75	356,51	353,71	-	170	315	54	51	1,5	16,00
HTD 90 14M 40	Cast iron	9A	40	3020	75	401,07	398,28	-	170	360	54	51	1,5	17,80
HTD 112 14M 40	Cast iron	9A	40	3020	75	499,11	496,32	-	170	457	54	51	1,5	25,60
HTD 144 14M 40	Cast iron	9A	40	3020	75	641,71	638,92	-	170	600	54	51	1,5	32,00
HTD 168 14M 40	Cast iron	9A	40	3020	75	748,66	745,87	-	170	706	54	51	1,5	44,00
HTD 192 14M 40	Cast iron	9A	40	3020	75	855,62	852,82	-	190	813	54	51	1,5	49,00
HTD 216 14M 40	Cast iron	9A	40	3020	90	962,57	959,76	-	190	920	54	51	1,5	55,00

Part No.	Material	Type	Belt width in mm	Taper bush	Ø Max.	Dimensions (mm)								Weight (kg)
						Dp	De	Df	Dm	Di	F	S	R	
HTD 28 14M 55	Steel	4F	55	2012	50	124,78	122,12	128	-	94	70	32	19	2,20
HTD 29 14M 55	Steel	4F	55	2012	50	129,23	126,57	138	-	100	70	32	19	2,74
HTD 30 14M 55	Steel	4F	55	2517	60	133,69	130,99	138	-	100	70	45	12,5	2,70
HTD 32 14M 55	Steel	4F	55	2517	60	142,60	139,88	154	-	108	70	45	12,5	3,66
HTD 34 14M 55	Steel	4F	55	2517	60	151,52	148,79	160	-	110	70	45	12,5	4,55
HTD 36 14M 55	Steel	4F	55	2517	60	160,43	157,68	168	-	120	70	45	12,5	5,20
HTD 38 14M 55	Steel	4F	55	2517	60	178,25	175,49	188	-	130	70	45	12,5	6,20
HTD 40 14M 55	Steel	4F	55	2517	60	178,25	175,49	188	-	138	70	45	12,5	7,00
HTD 44 14M 55	Steel	4F	55	3020	75	196,08	193,28	211	-	155	70	51	9,5	8,60
HTD 48 14M 55	Steel	4F	55	3020	75	213,90	211,11	226	-	170	70	51	9,5	10,40
HTD 56 14M 55	Steel	9WF	55	3020	75	249,55	246,76	256	170	208	70	51	9,5	12,40
HTD 64 14M 55	Cast iron	9WF	55	3020	75	285,21	282,41	296	170	240	70	51	9,5	14,50
HTD 72 14M 55	Cast iron	9W	55	3020	75	320,86	318,06	-	170	280	70	51	9,5	16,20
HTD 80 14M 55	Cast iron	9A	55	3020	75	356,51	351,71	-	170	315	70	51	9,5	17,50
HTD 90 14M 55	Cast iron	9A	55	3020	75	401,07	398,28	-	170	360	70	51	9,5	20,10
HTD 112 14M 55	Cast iron	9A	55	3020	75	499,11	496,32	-	170	457	70	51	9,5	28,40
HTD 144 14M 55	Cast iron	9A	55	3020	75	641,71	638,92	-	170	600	70	51	9,5	36,20
HTD 168 14M 55	Cast iron	9A	55	3020	75	748,66	745,87	-	170	706	70	51	9,5	49,00
HTD 192 14M 55	Cast iron	9A	55	3020	90	855,62	852,82	-	170	813	70	51	9,5	53,00
HTD 216 14M 55	Cast iron	7A	55	3535	90	962,57	959,76	-	190	920	70	89	9,5	65,80

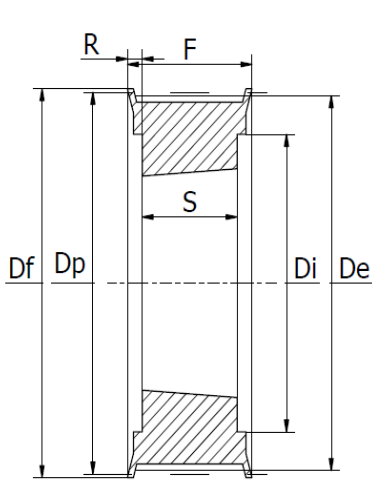

TYPE 4F

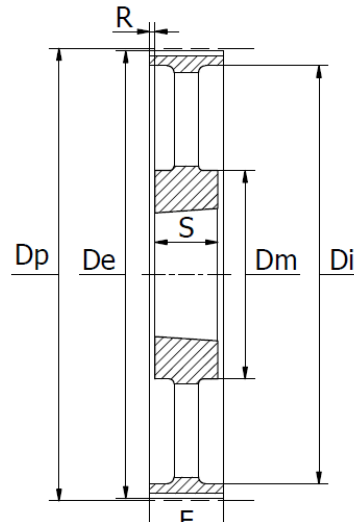

TYPE 9A

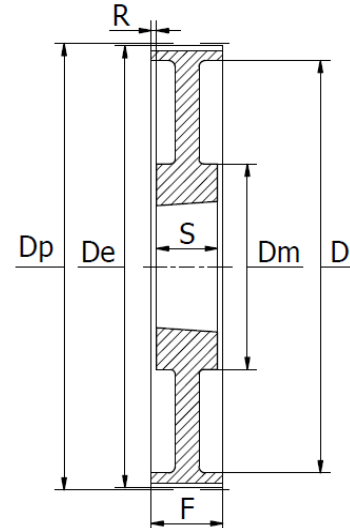

TYPE 9W

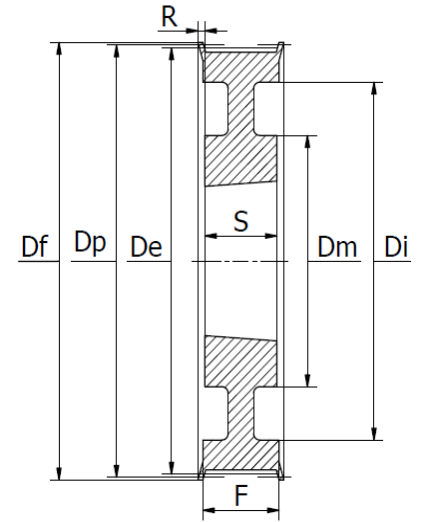

TYPE 9WF

Part No.	Material	Type	Belt width in mm	Taper bush	Ø Max.	Dimensions (mm)							Weight (kg)	
						Dp	De	Df	Dm	Di	F	S		R
HTD 28 14M 85	Steel	4F	85	2517	60	124,78	122,12	128	-	98	102	45	28,5	2,70
HTD 29 14M 85	Steel	4F	85	2517	60	129,23	126,57	138	-	100	102	45	28,5	3,40
HTD 30 14M 85	Steel	4F	85	2517	60	133,69	130,99	138	-	100	102	45	28,5	3,75
HTD 32 14M 85	Steel	4F	85	2517	60	142,60	139,88	154	-	108	102	45	28,5	4,80
HTD 34 14M 85	Steel	4F	85	2517	60	151,52	148,79	160	-	110	102	45	28,5	6,00
HTD 36 14M 85	Steel	4F	85	3020	75	160,43	157,68	168	-	120	102	51	25,5	5,80
HTD 38 14M 85	Steel	4F	85	3020	75	169,34	166,60	183	-	130	102	51	25,5	6,80
HTD 40 14M 85	Steel	4F	85	3020	75	178,25	175,49	188	-	138	102	51	25,5	8,00
HTD 44 14M 85	Steel	4F	85	3020	75	196,08	193,28	211	-	153	102	51	25,5	11,80
HTD 48 14M 85	Steel	4F	85	3020	75	213,90	211,11	226	-	170	102	51	25,5	15,10
HTD 56 14M 85	Steel	4F	85	3525	90	249,55	246,76	256	-	210	102	65	18,5	19,00
HTD 64 14M 85	Cast iron	4F	85	3525	90	285,21	282,41	296	190	240	102	65	18,5	23,00
HTD 72 14M 85	Cast iron	9W	85	3525	90	320,86	318,06	-	190	280	102	65	18,5	25,00
HTD 80 14M 85	Cast iron	9A	85	3525	90	356,51	353,71	-	190	315	102	65	18,5	26,00
HTD 90 14M 85	Cast iron	9A	85	3525	90	401,07	398,28	-	190	360	102	65	18,5	27,80
HTD 112 14M 85	Cast iron	9A	85	3525	90	499,11	496,32	-	190	457	102	65	18,5	36,80
HTD 144 14M 85	Cast iron	9A	85	3525	90	641,71	638,92	-	190	600	102	65	18,5	48,00
HTD 168 14M 85	Cast iron	9A	85	3525	90	748,66	745,87	-	190	706	102	65	18,5	60,00
HTD 192 14M 85	Cast iron	9A	85	4040	100	855,62	852,82	-	190	813	102	102	-	86,00
HTD 216 14M 85	Cast iron	9A	85	4040	100	962,57	959,76	-	190	920	102	102	-	91,50

Part No.	Material	Type	Belt width in mm	Taper bush	Ø Max.	Dimensions (mm)							Weight (kg)	
						Dp	De	Df	Dm	Di	F	S		R
HTD 28 14M 115	Steel	4F	115	2517	60	124,78	122,12	128	-	98	133	45	44	3,77
HTD 29 14M 115	Steel	4F	115	2517	60	129,23	126,57	138	-	100	133	45	44	4,00
HTD 30 14M 115	Steel	4F	115	2517	60	133,69	130,99	138	-	100	133	45	44	5,00
HTD 32 14M 115	Steel	4F	115	2517	60	142,60	139,88	154	-	108	133	45	44	6,80
HTD 34 14M 115	Steel	4F	115	2517	60	151,52	148,79	160	-	110	133	45	44	6,80
HTD 36 14M 115	Steel	4F	115	3020	75	160,43	157,68	168	-	125	133	51	41	7,00
HTD 38 14M 115	Steel	4F	115	3020	75	169,34	166,60	183	-	130	133	51	41	8,40
HTD 40 14M 115	Steel	4F	115	3020	75	178,25	175,49	188	-	138	133	51	41	9,20
HTD 44 14M 115	Steel	4F	115	3030	75	196,08	193,28	211	-	155	133	76	28,5	14,00
HTD 48 14M 115	Steel	4F	115	3030	75	213,90	211,11	226	-	170	133	76	28,5	17,10
HTD 56 14M 115	Steel	4F	115	3535	90	249,55	246,76	256	-	208	133	89	22	24,80
HTD 64 14M 115	Steel	9WF	115	3535	90	285,21	282,41	296	190	240	133	89	22	27,00
HTD 72 14M 115	Cast iron	9W	115	3535	90	320,86	318,06	-	190	280	133	89	22	29,00
HTD 80 14M 115	Cast iron	9A	115	3535	90	356,51	353,71	-	190	315	133	89	22	32,00
HTD 90 14M 115	Cast iron	9A	115	3535	90	401,07	398,28	-	190	360	133	89	22	36,50
HTD 112 14M 115	Cast iron	9A	115	3535	90	499,11	496,32	-	190	457	133	89	22	46,00
HTD 144 14M 115	Cast iron	9A	115	4040	100	641,71	638,92	-	230	600	133	102	15,5	68,00
HTD 168 14M 115	Cast iron	9A	115	4040	100	748,66	745,87	-	230	706	133	102	15,5	82,60
HTD 192 14M 115	Cast iron	9A	115	4040	100	855,62	852,82	-	230	813	133	102	15,5	96,00
HTD 216 14M 115	Cast iron	9A	115	4040	100	962,57	959,76	-	230	920	133	102	15,5	107,00

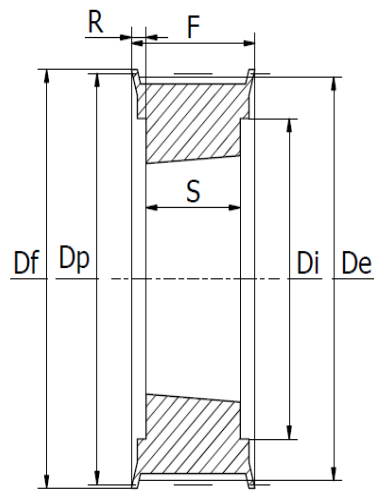

TYPE 4F

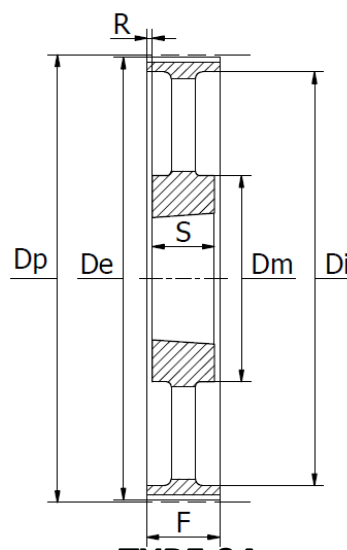

TYPE 9A

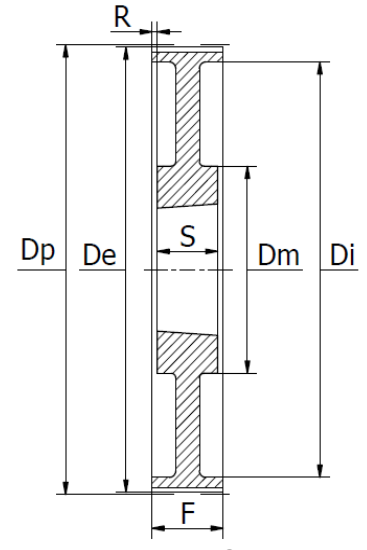

TYPE 9W

Part No.	Material	Type	Belt width in mm	Taper bush	Ø Max.	Dimensions (mm)							Weight (kg)	
						Dp	De	Df	Dm	Di	F	S		R
HTD 38 14M 170	Steel	4F	170	3030	75	169,34	166,60	183	-	130	187	76	55,5	11,70
HTD 40 14M 170	Steel	4F	170	3030	75	178,25	175,49	188	-	138	187	76	55,5	13,00
HTD 44 14M 170	Steel	4F	170	3535	90	196,08	193,28	211	-	153	187	89	49	15,00
HTD 48 14M 170	Steel	4F	170	3535	90	213,90	211,11	226	-	170	187	89	49	19,00
HTD 56 14M 170	Steel	4F	170	3535	90	249,55	246,76	256	-	208	187	89	49	28,50
HTD 64 14M 170	Cast iron	4F	170	4040	100	285,21	282,41	296	-	240	187	102	42,5	41,00
HTD 72 14M 170	Cast iron	9W	170	4040	100	320,86	318,06	-	230	280	187	102	42,5	46,90
HTD 80 14M 170	Cast iron	9W	170	4040	100	356,51	353,71	-	230	315	187	102	42,5	48,00
HTD 90 14M 170	Cast iron	9A	170	4040	100	401,07	398,28	-	230	360	187	102	42,5	52,50
HTD 112 14M 170	Cast iron	9A	170	5050	125	499,11	496,32	-	265	457	187	127	30	74,50
HTD 144 14M 170	Cast iron	9A	170	5050	125	641,71	638,92	-	265	600	187	127	30	91,00
HTD 168 14M 170	Cast iron	9A	170	5050	125	748,66	745,87	-	265	706	187	127	30	116,00
HTD 192 14M 170	Cast iron	9A	170	5050	125	855,62	852,82	-	265	813	187	127	30	134,00
HTD 216 14M 170	Cast iron	9A	170	5050	125	962,57	959,76	-	265	920	187	127	30	146,50