

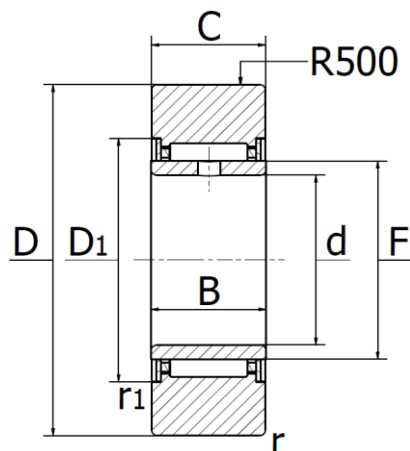

NA2000.2RS - Yoke type track rollers

Without axial guidance, lip seals on both sides. Curved outer race



Legend:

- F** Raceway diameter of inner ring
- R** Crowning radius
- Crw** Effective dynamic load rating as track roller (radial)
- C0rw** Effective static load rating as track roller (radial)
- Curw** Fatigue limit load
- nDG** Speed (with continuous operation and grease lubrication)

Part No.	Dimensions (mm)									Mass g	Load rating(N)			nDG (1/min)
	d	D	B	C	D1min	F	R	r1min	rmin		Crw	C0rw	Curw	
NA22/6.2RS	6	19	12,0	11,8	16	10	500,0	0,3	0,3	22,0	3900	3700	495	9000
NA22/8.2RS	8	24	12,0	11,8	18	12	500,0	0,3	0,3	34,0	4800	4300	650	7000
NA2200.2RS	10	30	14,0	13,8	20	14	500,0	0,3	0,6	60,0	7000	6900	1120	5500
NA2201.2RS	12	32	14,0	13,8	22,0	16	500,0	0,3	0,6	67,0	7500	8300	1290	4700
NA2202.2RS	15	35	14,0	13,8	26,0	20	500,0	0,3	0,6	75,0	7600	9900	1390	3400
NA2203.2RS	17	40	16,0	15,8	28,0	22	500,0	0,3	1,0	112,0	9900	14200	1870	3000
NA2204.2RS	20	47	18,0	17,8	33,0	25	500,0	0,3	1,0	177,0	14000	19300	2700	2300
NA2205.2RS	25	52	18,0	17,8	38,0	30	500,0	0,3	1,0	209,0	14400	21100	2950	1800
NA2206.2RS	30	62	20,0	19,8	43,0	35	500,0	0,3	1,0	324,0	17000	26500	3600	1400
NA2207.2RS	35	72	23,0	22,7	50,0	42	500,0	0,6	1,1	505,0	21500	36500	5300	1100
NA2208.2RS	40	80	23,0	22,7	57,0	48	500,0	0,6	1,1	628,0	26000	41500	5400	850
NA2210.2RS	50	90	23,0	22,7	68,0	58	500,0	0,6	1,1	690,0	26000	44000	5700	650