

Size 35 & 40

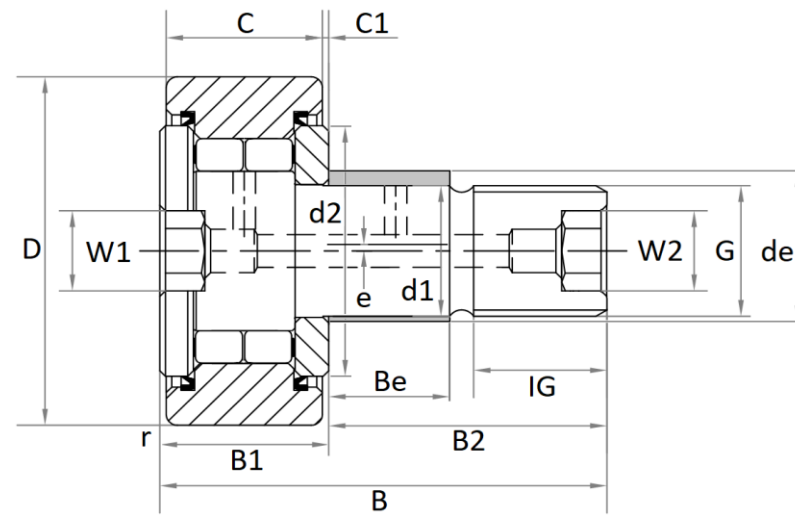

Size 47 to 90

Item No.	Dimensions (mm)														Mass (g)	M _A (Nm)	Load rating (N)					n _{DG} (1/min)		
	D	de	B	B1 max	B2	Be	C	C1	d1	d2	e	G	IG	r _{min}			W1	W2	C _{r w}	C _{0r w}	F _{r per}		F _{0r per}	C _{ur w}
NUKRE35	35	20	52	22,6	29,5	12	18	3,8	16	27,6	1	M16x1,5	17	0,6	8	8	177	58	15300	18700	8500	16800	2430	6500
NUKRE40	40	22	58	24,6	33,5	14	20	3,8	18	30	1	M18x1,5	19	1	8	8	258	87	18700	24900	13000	24900	3150	5500
NUKRE47	47	24	66	25,6	40,5	18	24	0,8	20	27	1	M20x1,5	21	1	10	10	400	120	28500	37500	16200	32500	4850	4200
NUKRE52	52	24	66	25,6	40,5	18	24	0,8	20	31	1	M20x1,5	21	1	10	10	470	120	29000	40500	17100	34500	5300	4200
NUKRE62	62	28	80	30,6	49,5	22	28	1,3	24	38	1	M24x1,5	25	1	14	14	824	220	40000	55000	23400	46000	7300	2600
NUKRE72	72	28	80	30,6	49,5	22	28	1,3	24	44	1	M24x1,5	25	1,1	14	14	1050	220	45000	65000	31500	63000	8700	2100
NUKRE80	80	35	100	37	63	29	35	1	30	47	1,5	M30x1,5	32	1,1	17	17	1670	450	69000	104000	47500	95000	14100	1800
NUKRE90	90	35	100	37	63	29	35	1	30	47	1,5	M30x1,5	32	1,1	14	14	2020	450	78000	123000	76000	123000	16700	1800

Legend:

- d_e Eccentric collar, Tolerance: h9
- B_e Eccentric collar
- d₁ Tolerance: h7
- W Nominal dimension for hexagonal socket
- M_A Nut tightening torque
- C_{r w} Effective dynamic load rating as track roller (radial)
- C_{0r w} Effective static load rating as track roller (radial)
- F_{r per} Permissible dynamic radial load
- F_{0r per} Permissible static radial load
- C_{ur w} Fatigue limit load
- n_{DG} Speed (with continuous operation and grease lubrication)

Lubrication nipple:

Every item is shipped with a drive fit lubrication nipple and a plug.

