

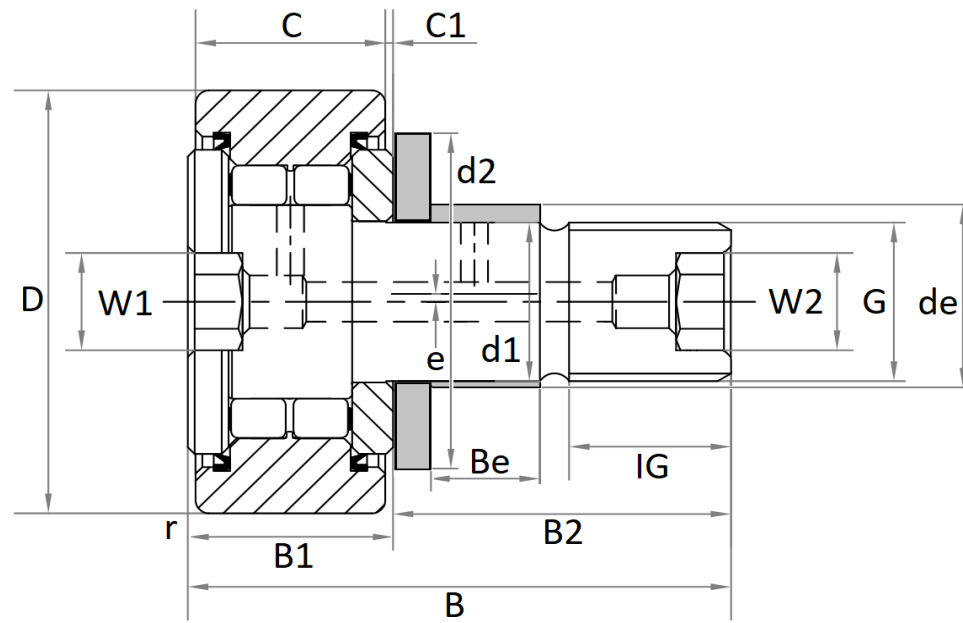

PWKRE..2RS Stud type track rollers

with axial guidance, eccentric collar, with lip seals, full complement cylindrical roller set



Size 35 & 40

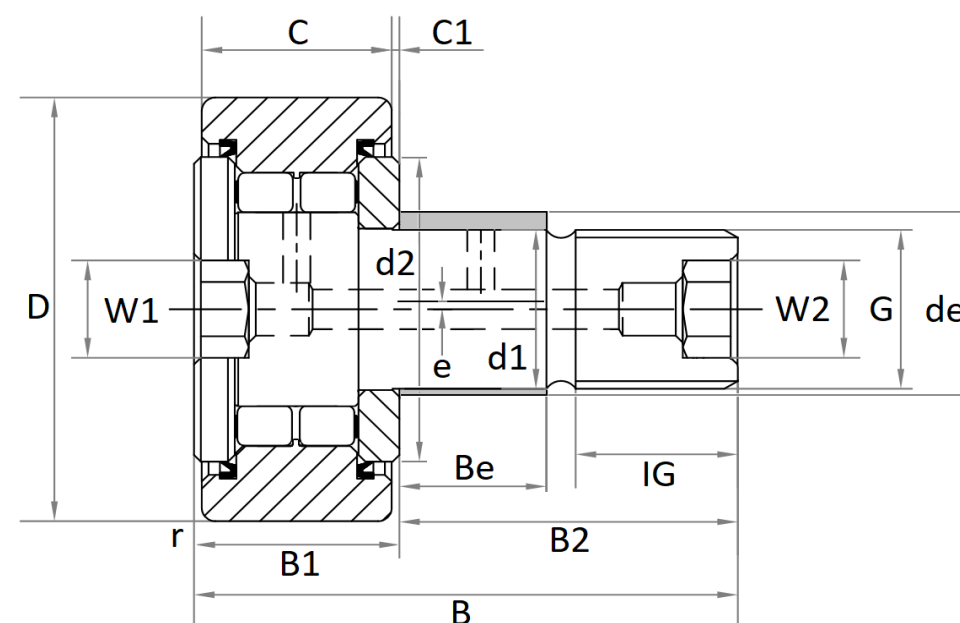

Size 47 to 90

| Item No. | Dimensions (mm) | | | | | | | | | | | | | | | | Mass (g) | M _A (Nm) | Load rating (N) | | | n _{DG} (1/min) |
|-------------|-----------------|----|-----|--------|------|----|----|-----|----|----|-----|---------|----|------------------|----|----|----------|---------------------|------------------|-------------------|-------------------|-------------------------|
| | D | de | B | B1 max | B2 | Be | C | C1 | d1 | d2 | e | G | IG | r _{min} | W1 | W2 | | | C _{r w} | C _{0r w} | C _{ur w} | |
| PWKRE35-2RS | 35 | 20 | 52 | 19,5 | 32,5 | 12 | 18 | 0,8 | 16 | 20 | 1 | M16X1,5 | 17 | 0,6 | 8 | 8 | 177 | 58 | 12600 | 14600 | 1760 | 6000 |
| PWKRE40-2RS | 40 | 22 | 58 | 21,6 | 36,5 | 14 | 20 | 0,8 | 18 | 22 | 1 | M18X1,5 | 19 | 1 | 8 | 8 | 258 | 87 | 14300 | 17900 | 2160 | 5000 |
| PWKRE47-2RS | 47 | 24 | 66 | 25,6 | 40,5 | 18 | 24 | 0,8 | 20 | 27 | 1 | M20X1,5 | 21 | 1 | 10 | 10 | 400 | 120 | 24500 | 30500 | 3750 | 3800 |
| PWKRE52-2RS | 52 | 24 | 66 | 25,6 | 40,5 | 18 | 24 | 0,8 | 20 | 31 | 1 | M20X1,5 | 21 | 1 | 10 | 10 | 470 | 120 | 25000 | 33000 | 4100 | 3800 |
| PWKRE62-2RS | 62 | 28 | 80 | 30,6 | 49,5 | 22 | 29 | 0,8 | 24 | 38 | 1 | M24X1,5 | 25 | 1 | 14 | 14 | 824 | 220 | 35000 | 45500 | 5800 | 2200 |
| PWKRE72-2RS | 72 | 28 | 80 | 30,5 | 49,5 | 22 | 29 | 0,8 | 24 | 44 | 1 | M24X1,5 | 25 | 1 | 14 | 14 | 1050 | 220 | 38500 | 54000 | 6900 | 2200 |
| PWKRE80-2RS | 80 | 35 | 100 | 37,6 | 63 | 29 | 35 | 1 | 30 | 47 | 1,5 | M30X1,5 | 32 | 1,1 | 14 | 14 | 1670 | 450 | 56000 | 79000 | 10600 | 1800 |
| PWKRE90-2RS | 90 | 35 | 100 | 37,6 | 63 | 29 | 35 | 1 | 30 | 47 | 1,5 | M30X1,5 | 32 | 1,1 | 14 | 14 | 2020 | 450 | 62000 | 92000 | 12200 | 1800 |

Legend:

- d₁** Tolerance: h7
- W** Nominal dimension for hexagonal socket
- M_A** Nut tightening torque
- C_{r w}** Effective dynamic load rating as track roller (radial)
- C_{0r w}** Effective static load rating as track roller (radial)
- C_{ur w}** Fatigue limit load
- n_{DG}** Speed (with continuous operation and grease lubrication)
- de** Eccentric collar, tolerance: h9
- e** Maximum eccentric collar offset

Lubrication nipple:

Every item is shipped with a drive fit lubrication nipple and a plug.

