

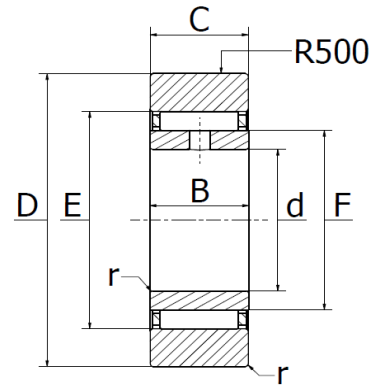

## STO - Yoke Type Track Rollers

Without axial guidance, outer ring without ribs, curved outer race



| Part No. | Dimensions (mm) |    |    |      |    |    |     | Mass             |     |                 |                  | ndG<br>(1/min) |                  |
|----------|-----------------|----|----|------|----|----|-----|------------------|-----|-----------------|------------------|----------------|------------------|
|          | d               | D  | B  | C    | E  | F  | R   | r <sub>min</sub> | g   | C <sub>rw</sub> | C <sub>0rw</sub> |                | C <sub>urw</sub> |
| STO6     | 6               | 19 | 10 | 9,8  | 13 | 10 | 500 | 0,3              | 17  | 3750,0          | 4600             | 660            | 10000            |
| STO8     | 8               | 24 | 10 | 9,8  | 15 | 12 | 500 | 0,3              | 26  | 4200,0          | 5600             | 800            | 8000             |
| STO10    | 10              | 30 | 12 | 11,8 | 20 | 14 | 500 | 0,3              | 49  | 8400,0          | 9500             | 1390           | 5500             |
| STO12    | 12              | 32 | 12 | 11,8 | 22 | 16 | 500 | 0,3              | 57  | 9000,0          | 10400            | 1560           | 4500             |
| STO15    | 15              | 35 | 12 | 11,8 | 26 | 20 | 500 | 0,3              | 63  | 9100,0          | 11100            | 1670           | 3300             |
| STO17    | 17              | 40 | 16 | 15,8 | 29 | 22 | 500 | 0,3              | 107 | 14200           | 18200            | 2550           | 2800             |
| STO20    | 20              | 47 | 16 | 15,8 | 32 | 25 | 500 | 0,3              | 152 | 16100           | 22000            | 3100           | 2400             |
| STO25    | 25              | 52 | 16 | 15,8 | 37 | 30 | 500 | 0,3              | 177 | 16400           | 23500            | 3350           | 1800             |
| STO30    | 30              | 62 | 20 | 19,8 | 46 | 38 | 500 | 0,6              | 308 | 23100           | 35500            | 4800           | 1300             |
| STO35    | 35              | 72 | 20 | 19,8 | 50 | 42 | 500 | 0,6              | 441 | 25000           | 41000            | 5500           | 1100             |
| STO40    | 40              | 80 | 20 | 19,8 | 58 | 50 | 500 | 1,0              | 530 | 23700           | 40000            | 6000           | 850              |
| STO45    | 45              | 85 | 20 | 19,8 | 63 | 55 | 500 | 1,0              | 576 | 25000           | 44000            | 6000           | 750              |
| STO50    | 50              | 90 | 20 | 19,8 | 68 | 60 | 500 | 1,0              | 617 | 25500           | 47000            | 6400           | 650              |

### Legend:

- F Raceway diameter of inner ring
- R Crowning radius
- C<sub>rw</sub> Effective dynamic load rating as track roller (radial)
- C<sub>0rw</sub> Effective static load rating as track roller (radial)
- C<sub>urw</sub> Fatigue limit load
- ndG Speed (with continuous operation and grease lubrication)